

DENA AFFORDABLE HOUSING PROJECT



Above designs are just for example



our nanotech future

DENA AFFORDABLE HOUSING PROJECT

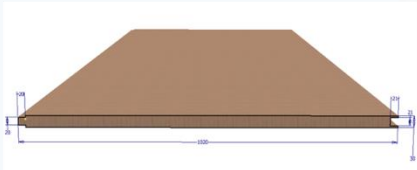

Roofing



Board/sheet

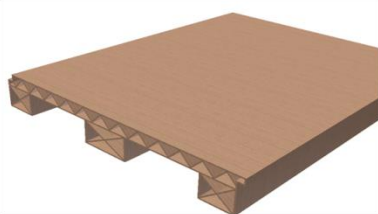

Flooring

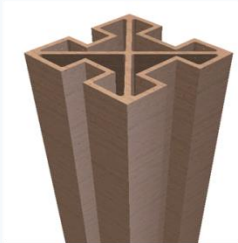

Post



Door

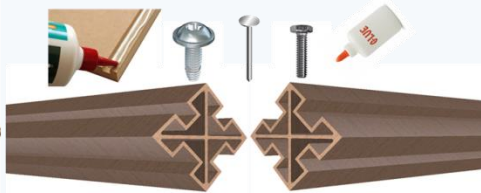

our nanotech future

www.dena.co.uk

www.dena.co.uk

Products needed for the construction of Dena Affordable Housing

Following products will be need to construct the affordable house

Door



Post

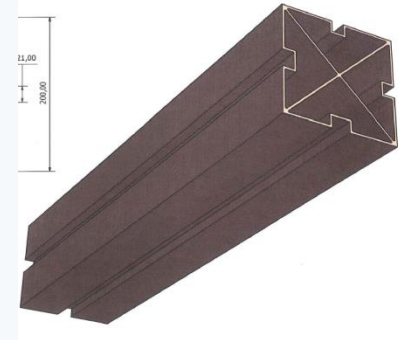

Dena Affordable House

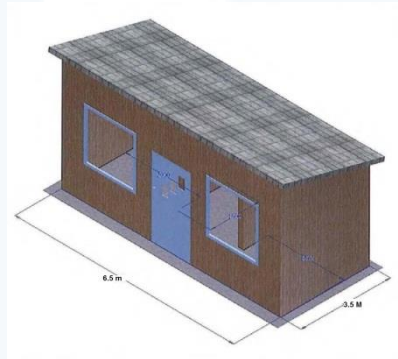

Flooring

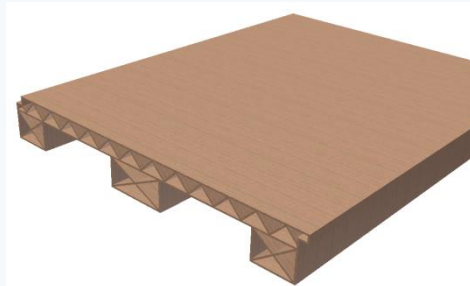

Wall Sheets



Dena machines can produce products of almost all shapes and sizes. The size of the door to be produced will be 2040x830x40mm. Door is extruded in 1 single piece giving it more strength over wooden doors. It will weigh around 22 Kg therefore; machine will produce around 45 doors in 1 ton. Doors can be made wider or slimmer as per the requirement, this will reflect in its weight. We can produce doors in various colours as per requirement.

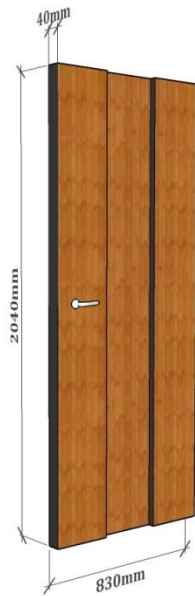

POST

1 or 2 machines is needed to produce square post, which is specially designed to support the structure of the house. All the walls and roofing will be put together using these post. Dimension of the post will be approx. 1000 x 100 x 100 or 1000 x 200 x 200 and will weigh approx. 4.5 kg or 8 kg per given post.

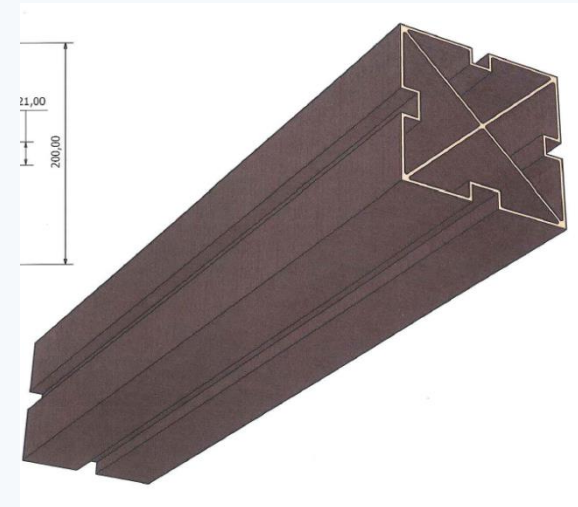
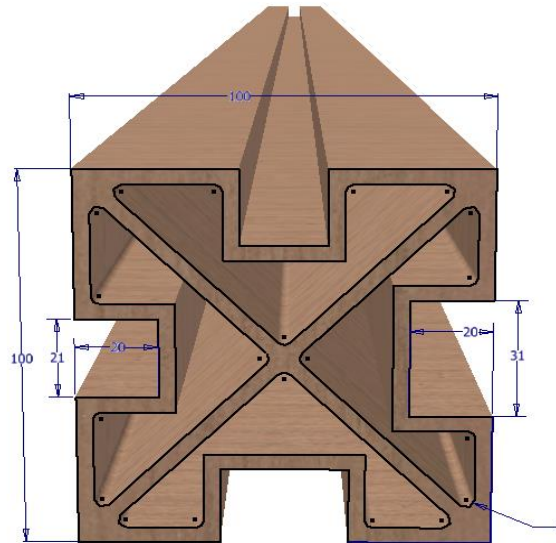
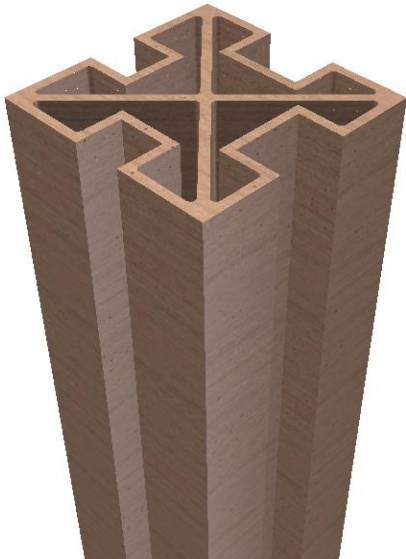

FLOORING

Flooring can be made solid or profiled. A solid sheet is designed for heavy duty load. However, we recommend to go for profiled flooring as it is strong enough for the job and at the same time it will reduce the over all weight of the house resulting in reduced production cost. Dimension of the flooring will be approx 1000 x 820 x 110 with approx weight of 20.8kg. Therefore we will produce around 48 flooring sheets in 1 ton.

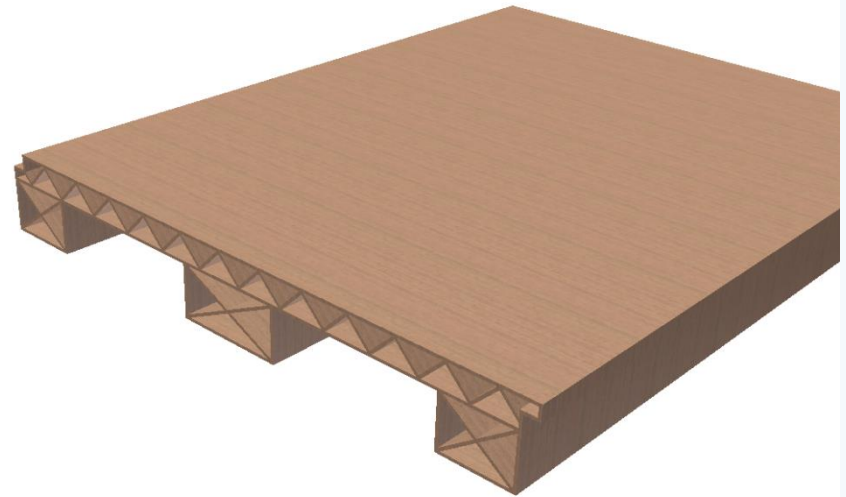
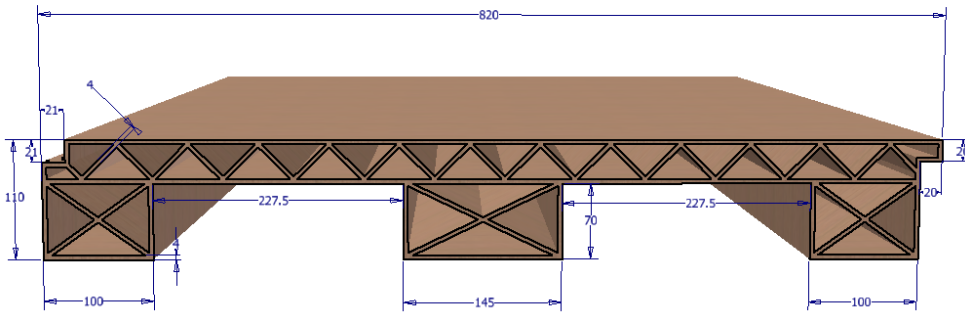

ROOFING

Roofing too will be made using profiled design to reduce the weight and increase strength. Dimension of roofing will be 1000x502x20 and weighing around 5.5 kg approx.. Therefore we will end up producing around 181 roofing tiles in 1 ton.

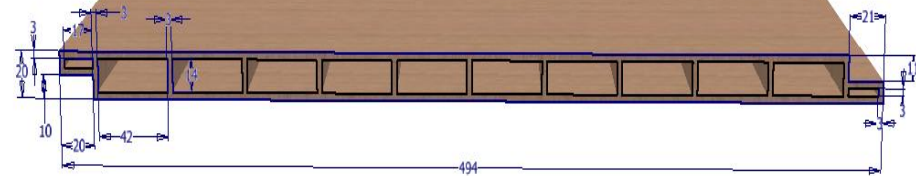

BOARDS

To make affordable housing, we need to produce wall and roofing along with doors.. We can have flat and solid sheet or we can go for a profile sheet with pattern on it. Profiled sheets is the smarter way to go forward as it is lighter and stronger compared to solid sheet. Sheets can be color coded to match the customer demand. Size of a wall sheet/board will be approx (1000 x 1020 x 30) mm. Each board will weigh approx. 15kg, therefore we will have around 66 boards in 1 ton.

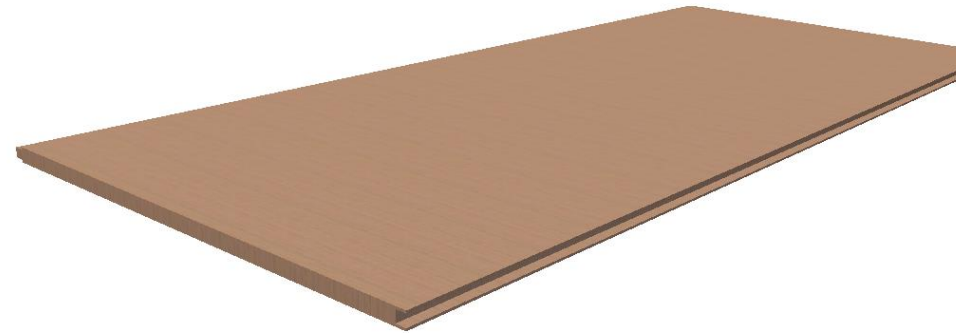
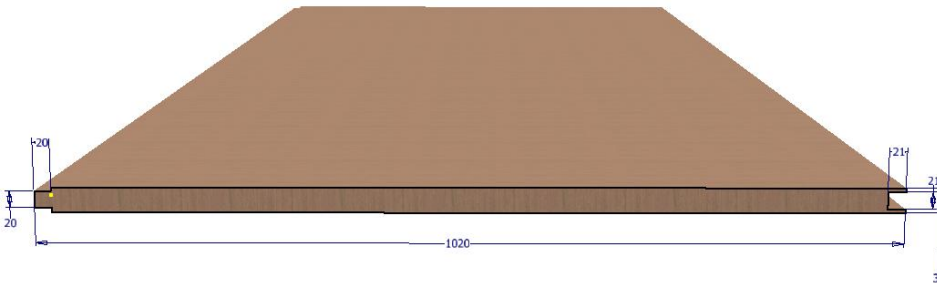



our nanotech future

CONSTRUCTION PROCESS

- All our products are made from a very durable recycled material that has the properties of rubber and plastics but look like wood. Our material is far superior compared to wood in terms of strength, water resistance, fire resistance etc. Our products can be cut, drilled, screwed, nailed, glued and painted just like wood. In fact our products holds nails and screws better than wood.
- All the house components can be joined together by using nail, screw, bolt and glue. We can apply glue if required.

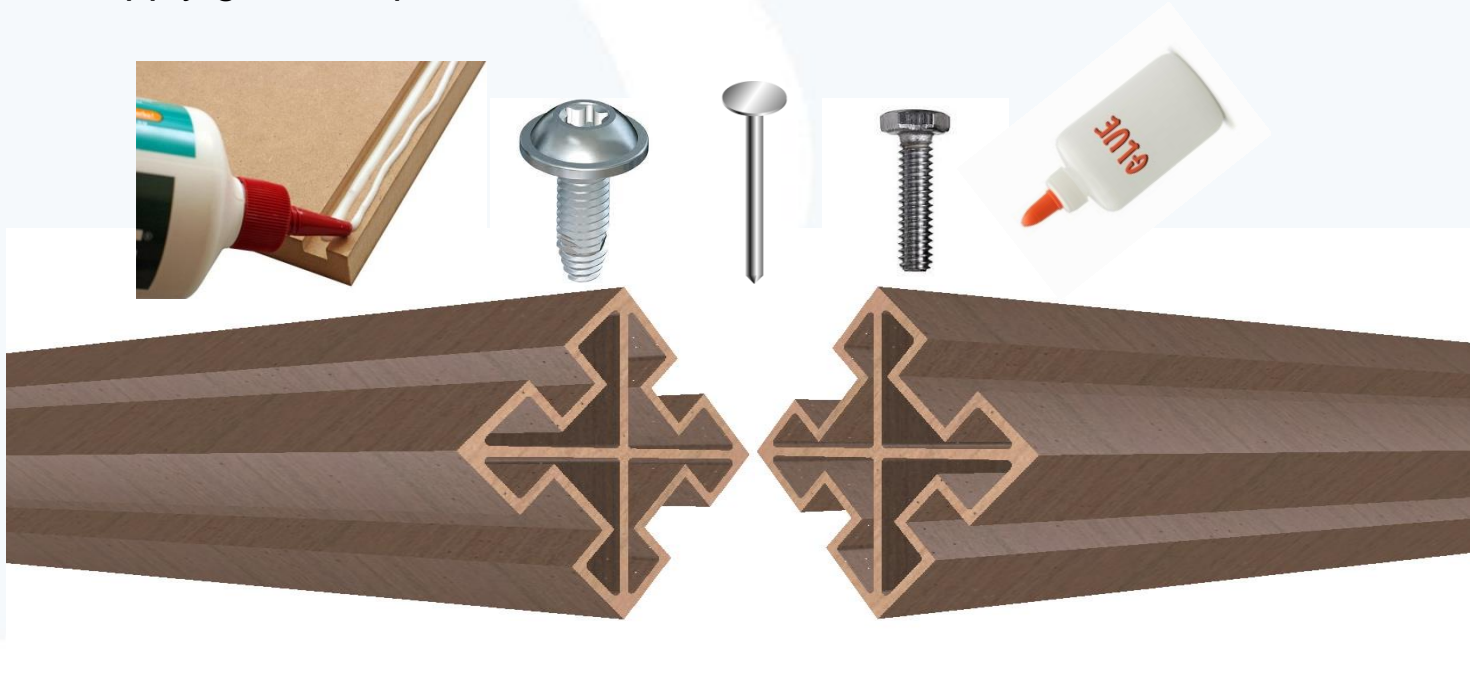



our nanotech future

THANK YOU

www.dena.co.uk